

# 3Megapixel FULL HD IP Camera

## VD102SM3Ti Indoor Dome Camera

H.264 / M-JPEG Triple Stream, 3.0 Megapixel Sony CMOS Sensor, Day/Night,

**Max. 3M (2048 x 1536) resolution**, Night Vision with IR LED's, Micro-SD Local storage

Model: VD102SM3Ti/VD102SM3Ti-IR(Night Vision)



Driving IP-based physical security  
through global standardization

*The Vision VD102SM3Ti IP Camera is designed for any networked surveillance application.*

*Megapixel Resolution combined with state-of-the-art features sets it apart from other network cameras on the market today.*

*The VD102SM3Ti provides high definition 1080p IP video for the most critical video surveillance applications*

**Conformant with ONVIF Core 2.2**

## Features

- 3.0 Mega pixel 1/2.8" SONY progressive scan CMOS image sensor for excellent image quality
- Perfect tool-free 3-Axis mechanism inside
- Patented intelligent IR protection technology (VD102SM3Ti-IR)
- Extended IR life cycle (VD102SM3Ti-IR)
- multi Streaming of H.264 and M-JPEG
- Supports image resolutions up to 3Mega Pixel (2048x1536)
- Integrated motion detection with pre- and post-alarm image/video buffering
- Micro-SD Local storage, event triggered, scheduled and continuous recording supported
- **Event-triggered FTP and email upload of still images**
- Digital PTZ
- UPnP supported



Product info [support@visionhitech.co.kr](mailto:support@visionhitech.co.kr)  
Marketing [yht@visionhitech.co.kr](mailto:yht@visionhitech.co.kr)

- 1 Port analog video loop-out port
- external sensors devices
- Supports CBR (constant bit rate) and VBR (variable bit rate) modes
- Controllable frame rate
- Video access through any standard Web browser
- Privacy Masking up to 4 areas
- Integrated HTTP Web server supporting 16 simultaneous user connections
- HTTPS supported (Hyper Text Transfer Protocol Secured)
- Integrated E-Mail, FTP, DDNS and DHCP client
- Extensive CGI API for software integration and remote programming operations
- Includes Windows based IP Installer and License-free 16 channel NVR software

## Specifications

Classification		Specification	
		VD102SM3Ti	VD102SM3Ti-IR
General	CPU	32-bit ARM9 RISC CPU up to 432MHz	
	Flash	128Mbyte	
	SDRAM	128Mbyte	
Image Pickup	Image sensor	3.0 Megapixel 1/2.8" SONY progressive scan CMOS image sensor	
	Total Pixels	2144(H) x 1588(V) 3.4 Megapixel	
	Effective Pixels	2096(H) x 1561(V) 3.27 Megapixel	
	S/N Ratio	More than 50dB	
	Min. Illumination & IR Distance	1 Lux with DSSX2 (F1.2, 30IRE, AGC On)	0Lux (IR On) 30M (21 Built-in IR LED's)
	Day & Night	Electronic	ICR Filter Changer
	Lens Control	DC Iris	
	Lens(Standard)	2.8~12mm Vari-focal Megapixel Lens	
Video	Video compression	H.264 High profile @Level 4.0, Motion JPEG	
	Resolutions	Up to 2048 x 1536	
	Frame rate	H.264:3M 20fps, 1080p 30fps/MJPEG:VGA 30fps	
	Video streaming	Support multi stream with H.264, MJPEG	
		Adjustable frame rate	
		VBR/CBR in H.264	
	Pan/Tilt/Zoom	Digital PTZ	
Image setting	Day & Night		



		Auto White Balance	
		Auto Exposure	
		Privacy Mask	
		Effect - Color, Sharpness, Mirror/V-Flip, etc.	
	Output	BNC x1, 1.0Vp-p, 75 ohm Composite Video, NTSC/PAL	
Network	Security	Password protection	
		User access log	
		HTTPS encryption	
	Supported protocol	HTTP, HTTPS, FTP, SMTP, UPnP, DNS, DynDNS, NTP RTSP, RTP, TCP, UDP, ICMP, DHCP	
System integration	Intelligent video	Motion detection up to all resolution with 4x3 blocks	
	Alarm trigger	Motion detection	
		External input/Normal Open/Close Type	
	Alarm events	File upload via ftp, e-mail	
		Notification via email, FTP and TCP	
	Video buffer	5MB pre-alarm and post-alarm 180sec	
	Recoding	Save to SD/SDHC card with event mode and continuous mode	
	Firmware upgrade	Remote upgrade via network	
API	CGI Interface document		
	ActiveX Interface(ocx(dll) + document)		
etc	Reset Button	1 x Factory Reset Button	
Physical	Power Source	DC 12V/1.5A	
	Power Consumption	Max. 5.5W	Max. 7.2W with IR On
	Net Weight	520g Appr.(Camera Only)	
	LED's	Power, Network Connection	
	Dimension	132(Φ) x 106.7(H)	
Environment	Operating Temperature	-10 degree~50 degree Celsius(14F~122F)	
	Storage Temperature	-20 degree~60 degree Celsius(-4F~140F)	
Software	Included Software	NVR Lite (16 Channel), IP Installer (Windows only)	
Package	Package Contents	Network Camera, Use Manual, External Power Adaptor, Software CD	

■ Specifications are subject to change without prior notice to enhance performance and stability



Product info [support@visionhitech.co.kr](mailto:support@visionhitech.co.kr)  
Marketing [yht@visionhitech.co.kr](mailto:yht@visionhitech.co.kr)

## Dimension

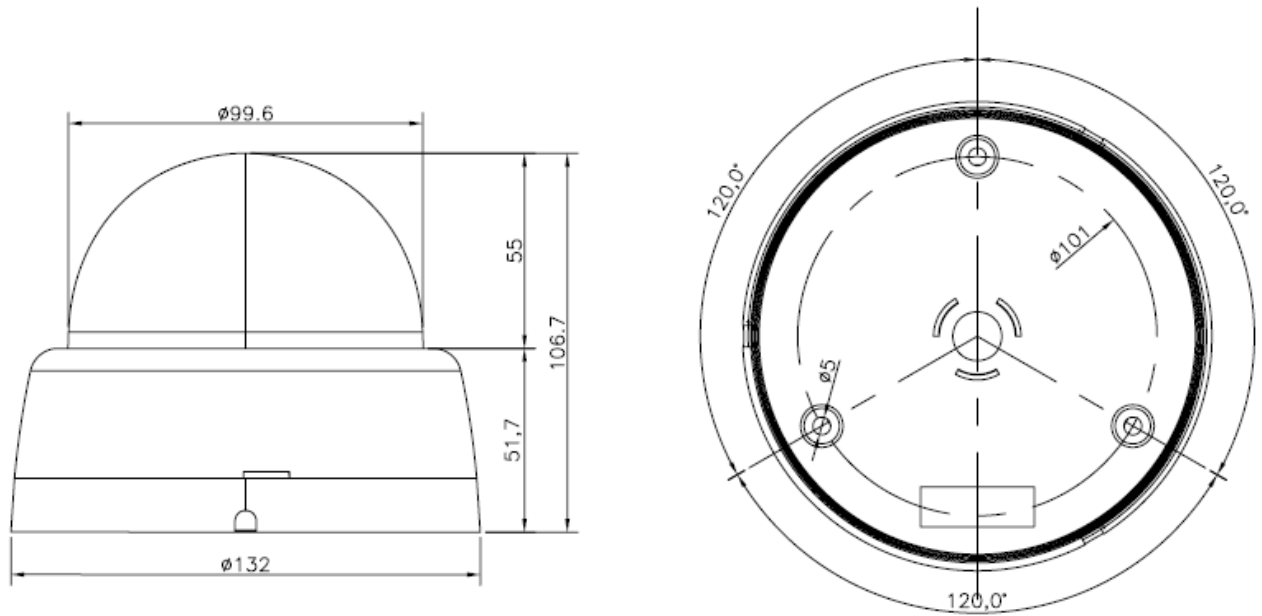

## Connectors

